

# Dolphin Village

Pinellas County Tampa-St. Petersburg-Clearwater, FL 135,796 Sq Ft

4655 Gulf Boulevard | St. Pete Beach, FL 33706

277.223, -82.7393

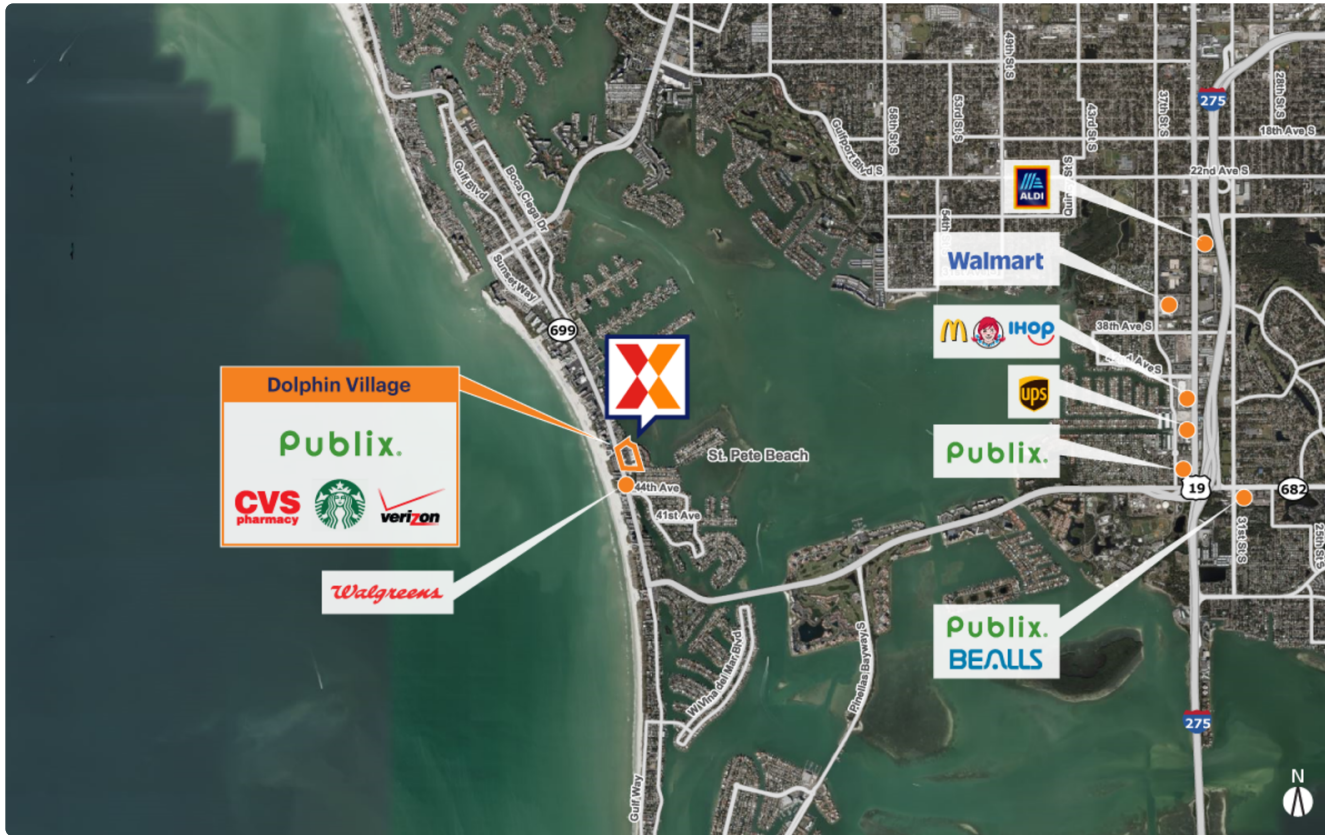

Demographics	1 Mile	3 Miles	5 Miles
Population	2,881	35,313	107,827
Daytime Pop.	4,083	33,973	106,321
Households	1,524	19,242	51,664
Income	\$207,792	\$145,732	\$124,621

Source: Synergos Technologies, Inc. 2024

Publix-anchored center with strong lineup of regional and national retailers including Chick-fil-A, The UPS Store, Starbucks, and more

Uniquely located on a barrier island, the center is the sole retail destination within 2+ miles, serving nearby hotels, condominiums, and public beach area

Highly visible to 23K+ vehicles daily along Gulf Blvd (Kalibrate 2021)

Benefits from a swell in seasonal visitors, increasing the population within a 3-mile radius by an average of 48% over the course of the year



# Dolphin Village

4655 Gulf Boulevard | St. Pete Beach, FL 33706

Pinellas County Tampa-St. Petersburg-Clearwater, FL 135,796 Sq Ft

277.223, -82.7393

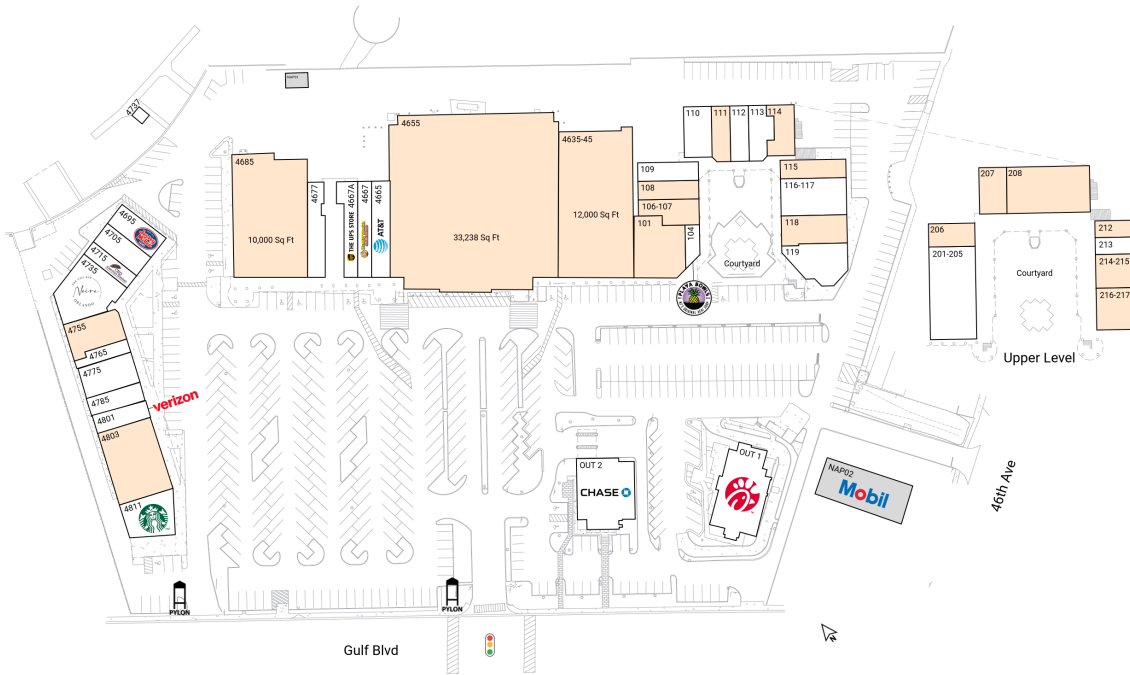

## Available Spaces

101	2,525 Sq Ft	360°	208	4,500 Sq Ft	360°
106-107	1,838 Sq Ft		212	1,000 Sq Ft	
108	1,300 Sq Ft		214-215	2,000 Sq Ft	
111	1,188 Sq Ft		216-217	2,478 Sq Ft	
114	1,451 Sq Ft		4635-45	12,000 Sq Ft	360°
115	1,400 Sq Ft	360°	4655	33,238 Sq Ft	
118	2,000 Sq Ft		4685	10,000 Sq Ft	
206	1,202 Sq Ft		4755	2,105 Sq Ft	360°
207	1,498 Sq Ft		4803	4,800 Sq Ft	360°

## Current Tenants Space size listed in square feet

104	Playa Bowls	703	4705	Buona Pizza	1,500
109	Phuong's Jewelry	1,300	4715	CBD American Shaman	1,000
110	The Fashion Spot	1,650	4735	Noire the Nail Bar	3,150
112	Alano Beach Club	1,200	4737	Dolphin Landings	0
113	Beach Vibe Cycle Rentals	1,387	4765	Beach Zone Ice Cream	822
116-117	Top Shape Gym	2,800	4775	Dolphin Village Liquors	2,040
119	Shattered Glass Art Studio	2,536	4785	Indian Bistro	1,200
201-202	Paramount	5,000	4801	Verizon Wireless	1,200
05	Ballroom		4811	Starbucks	2,319
213	Salon Ancora	1,000	OUT	Chick-fil-A	4,571
4665	AT&T	2,000	1		
4667	Hungry Howie's Pizza & Subs	1,500	OUT	Chase	4,195
4667	The UPS Store	1,500	2		
A			NAP	Dolphin Landings	0
4677	Swim N Play	1,600	01		
4695	Jersey Mike's	1,500	NAP	Mobil	0
			02		

This site plan is for illustrative and information purposes only, showing the general layout of the shopping center; and is not a legal survey. Brixmor makes no representation or warranty that the shopping center is exactly as depicted as site conditions and tenant mix are subject to change over time. 1828

